

NOTES
 Do not scale from this drawing. Only figured dimensions are to be taken from this drawing.
 Contractor must verify all dimensions on site before commencing any work or shop drawings.
 Work within the Gibraltar Construction (Design & Management) Regulations is not to start until a Health and Safety Plan has been produced.
 This Drawing is Copyright and must not be reproduced without consent of GCArchitects.
 This drawing originates from the CAD file: Projects?
 Rev. Description Drawn Date Checked Date

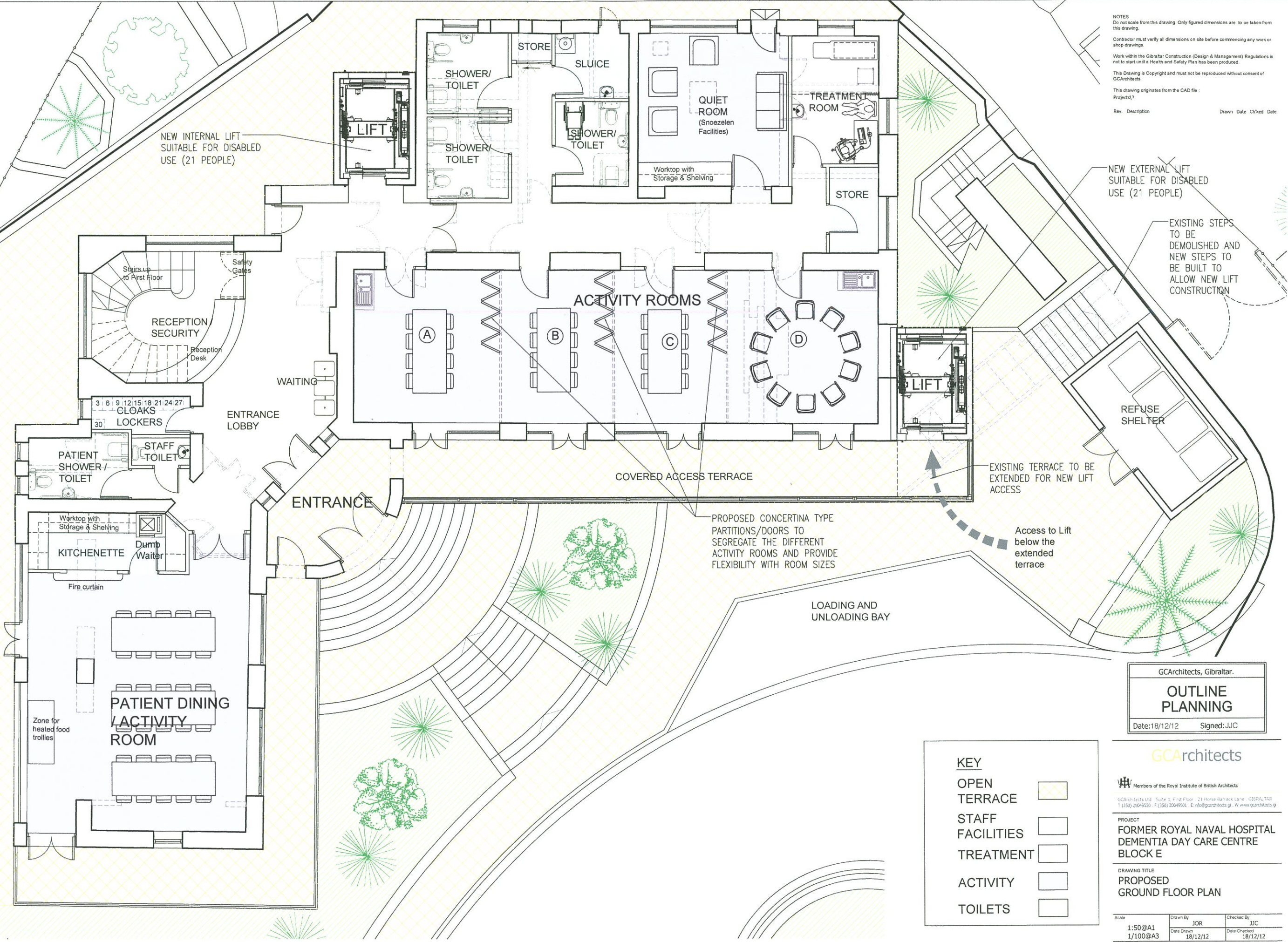

FORMER ROYAL NAVAL HOSPITAL - BLOCK E
 PROPOSED DEMENTIA DAY CARE CENTRE - GROUND FLOOR PLAN

GCArchitects, Gibraltar.
OUTLINE PLANNING
 Date: 18/12/12 Signed: JJC

KEY	
OPEN TERRACE	
STAFF FACILITIES	
TREATMENT	
ACTIVITY	
TOILETS	

GCArchitects
 Members of the Royal Institute of British Architects
 GCArchitects Ltd, Suite 3, First Floor, 23 Horse Bazaar Lane, Gibraltar, T: (350) 2504950, F: (350) 2004950, E: info@gcarchitects.gi, W: www.gcarchitects.gi
 PROJECT
 FORMER ROYAL NAVAL HOSPITAL
 DEMENTIA DAY CARE CENTRE
 BLOCK E
 DRAWING TITLE
 PROPOSED
 GROUND FLOOR PLAN
 Scale: 1:50@A1, 1:100@A3
 Drawn By: JOR, Date Drawn: 18/12/12
 Checked By: JJC, Date Checked: 18/12/12
 Drawing Status: OUTLINE PLANNING
 DRAWING NO.
 09012/E/OP301